

# Look Ahead | Arts Programme

HOUSING AND CARE

## Rainforest Walk, Bracknell Forest Borough Council, 2002-04

For Look Ahead's new project for homeless young people in Bracknell, artist Esther Rolinson has worked with architects Prior Manton Tuke Powell designing a light work for the building. Rolinson was selected with involvement from local residents. The artist and architects undertook a residency at neighbouring Foxhill Primary School with Year 5 students exploring the design of the building and ideas of home and community, making links with art, design and citizenship in the National Curriculum. The artist and architects designs have been show at residents consultation meetings. The programme is supported by Arts Council England, South East and from the capital costs of the building scheme.

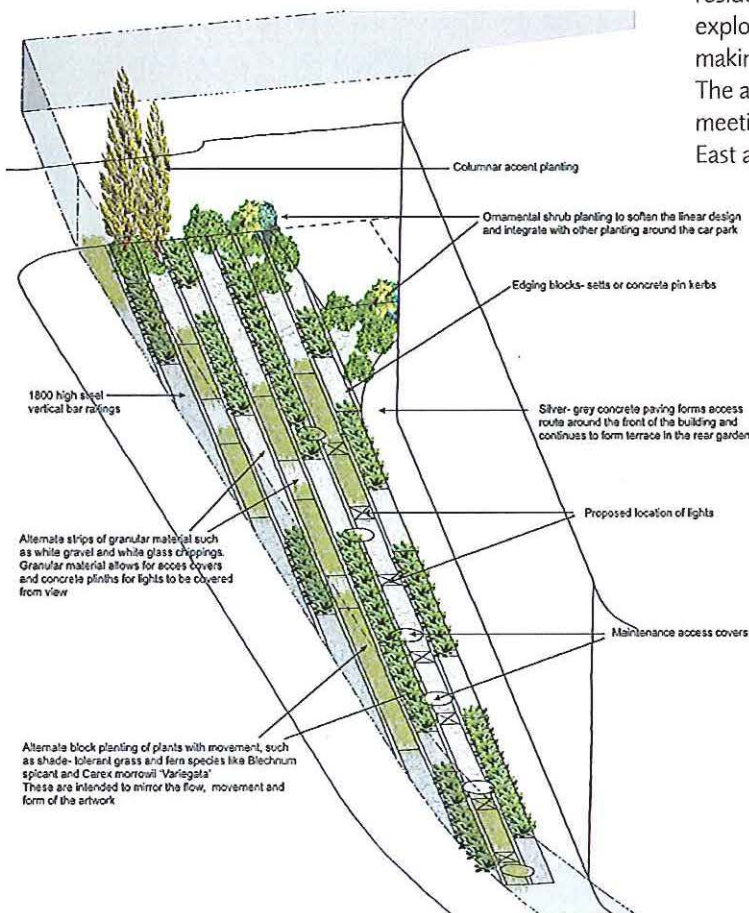

### PONDMOOR ROAD LANDSCAPE

PRELIMINARY SKETCH SCHEME PROPOSAL FOR LANDSCAPE TREATMENT TO FRONT OF BUILDING

2415/SK/001 SCALE 1:100 AUGUST 2003

Design for landscape for Rainforest Walk, LB Landscape Architecture



Students from Foxhill Primary School re-named Rainforest Walk  
Photo: Stewart Turkington

# Look Ahead | Public art commissions

HOUSING AND CARE



**Rainforest Walk,  
Bracknell Forest  
District Council, 2004**

Young people from Rainforest Walk discuss designs for the commission with Esther Rolinson  
Photo: Ian Craig

'Air Wave' was created by Esther Rolinson for Look Ahead's new project for young people in Bracknell. The acrylic panels of the art work seem part of the architecture of the building, while at night they emit a glow. Rolinson was selected with local residents. As part of the project the artist and architects Prior Manton Tuke Powell undertook a residency at neighbouring Fox Hill Primary School making links with art, design and citizenship in the National Curriculum. Rolinson has discussed her commission with young people and staff at Rainforest Walk and local people.



**Students from Fox Hill Primary School  
re-named Rainforest Walk**  
Photo: Stewart Turkington

'Air Wave' acrylic and light wall, 2004, Esther Rolinson  
Detail of 'Air Wave' acrylic and light wall, 2004, Esther Rolinson  
Photos: Ian Craig